



Municipal District of Foothills No. 31

309 Macleod Trail, Box 5605
High River, Alberta T1V 1M7
Telephone: (403) 652-2341 OR (403) 931-1905
Fax: (403) 652-7880
www.mdfoothills.com

July 29th, 2006

Municipal Government Board
15th Floor, Commerce Place
10155-102 Street
Edmonton, Alberta
T5J 4L4

Mary Axworthy
Director of Planning and Policy
City of Calgary
PO Box 2100, Station M (8117)
Calgary, AB, T2P 2M5

Dear Sir/Madam:

RE: Formal initiation of the MD of Foothills Annexation Application

In accordance with Section 116 of the Municipal Government Act and pursuant to a motion of the MD of Foothills Council dated July 6th, 2006, the MD of Foothills is giving written notice to the City of Calgary and the Municipal Government Board of the initiation of the proposed of annexation of lands into the MD of Foothills.

The lands intended for annexation are those within the City of Calgary owned by Spruce Meadows. Currently one title within the NW quarter of 20-22-01-W5M containing 117.4 acres is partially within the City of Calgary and partially within the MD of Foothills. Four additional titles within the NE quarter of 20-22-01-W5M owned by Spruce Meadows are within the City of Calgary boundary. These lands, located adjacent to the south boundary of 22x and the TUC, west of 14th Street (City of Calgary numbering) also known as Spruce Meadows Way include the following legal descriptions:

Legal Description					
Quarter	Block	Plan	Title #	Ha	Ac
Ptn. NW 20-22-01-W5M			961300431 +2	47.5	117.4
Ptn. NE 20-22-01-W5M			961300431 +1	0.73	1.80
Ptn. NE 20-22-01-W5M			961300431	0.86	2.12
Ptn. NE 20-22-01-W5M	1	9711350	9710210752	15.68	38.75
Ptn. NE 20-22-01-W5M	G	5347JK	061030366	7.43	18.36
Lands in MD of Foothills within ptn. NW of 20 (title # 96130031 +2)				-16.18	-40
Total lands proposed for annexation into MD of Foothills				56.02	138.43

The annexation proposes to include approximately 138.43 acres owned by Spruce Meadows within the NW and NE quarters of 20-22-01-W5M into the MD of Foothills.

The world renowned equestrian facility has ownership of 314.39 acres, of which 175.96 acres are located in the MD of Foothills and 138.43 acres are located in the City of Calgary. Additional lands surrounding the facility are under lease agreement. The purpose of the annexation is to allow Spruce Meadows to operate under the jurisdiction of one Municipality instead of two. The owners of Spruce Meadows have requested that their operation be located fully within a rural setting. The MD of Foothills is pleased to be able to accommodate this request and as such has initiated the annexation of these lands.

The strategy proposed for the annexation procedure is to facilitate meetings of an Annexation Committee consisting of Council members of the MD of Foothills and the City of Calgary with respective staff assistance. A concurrent referral circulation and public consultation process will be undertaken in order to determine what concerns or objections may exist with respect to the annexation proposal.

In conclusion, we look forward to working collaboratively with all parties to proceed with the annexation.

Sincerely



Heather Hemingway CIP, MCIP

Municipal Planner

MD of Foothills No. 31

cc Randy Fedorak, Vice President, Spruce Meadows

Attachments

1. Map #1 Spruce Meadows lands subject to annexation proposal
2. Map #2, Regional Context of lands subject to annexation proposal
3. Copy of Council Resolution

Annexation of Spruce Meadows Lands (Section 20 22-01 W5)

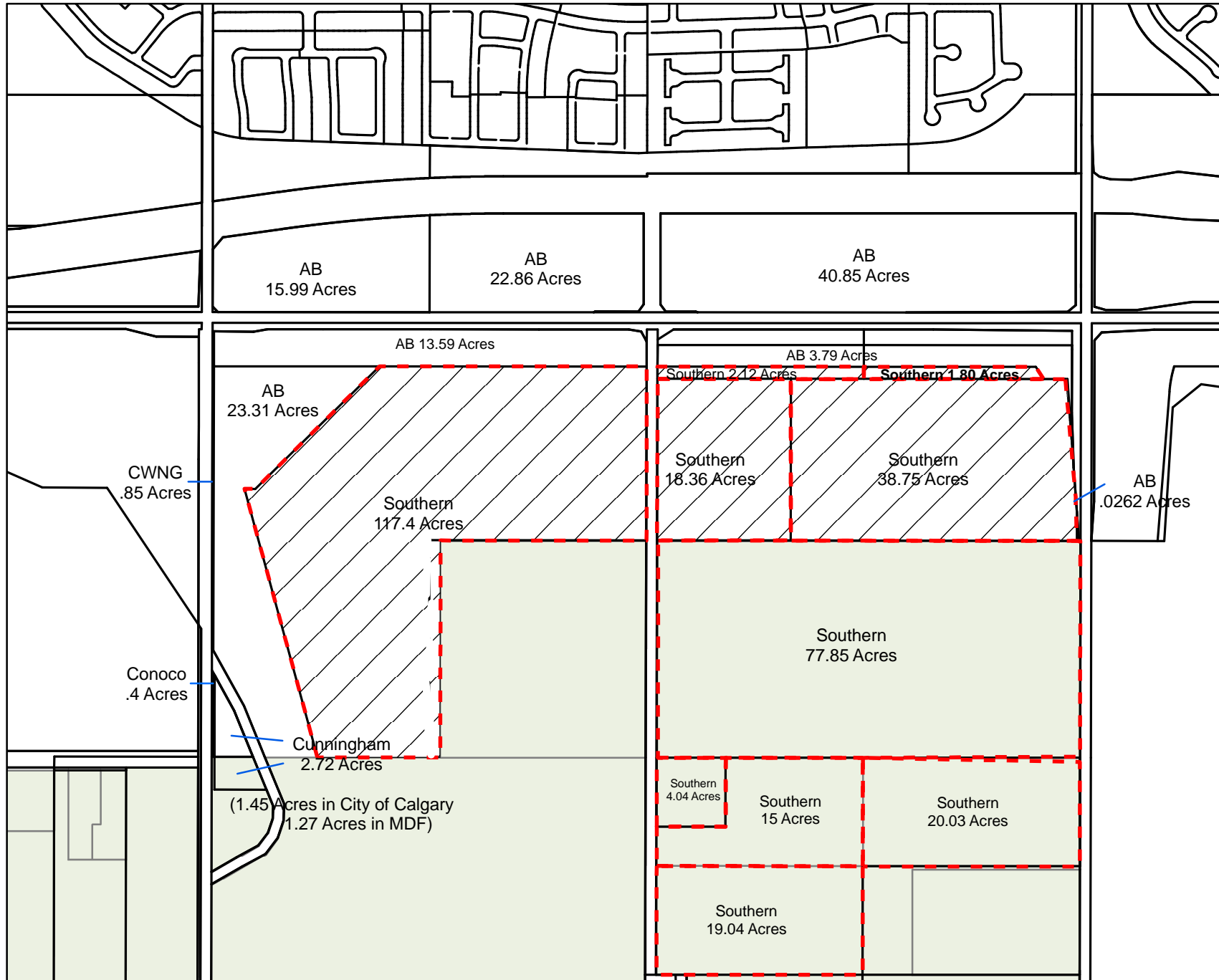

Legend

- City of Calgary
- Municipal District of Foothills No.31
- Southern Properties
- Lands Proposed for Annexation

Scale 1:10,045





Aug 1, 2006

Map is compiled by the Municipal District of Foothills No. 31. Reproduction, in whole or in part, is prohibited without express permission from the Municipal District of Foothills No.31. Data Sources include Municipal Records and A&L/S. This map is for graphic representation purposes only.

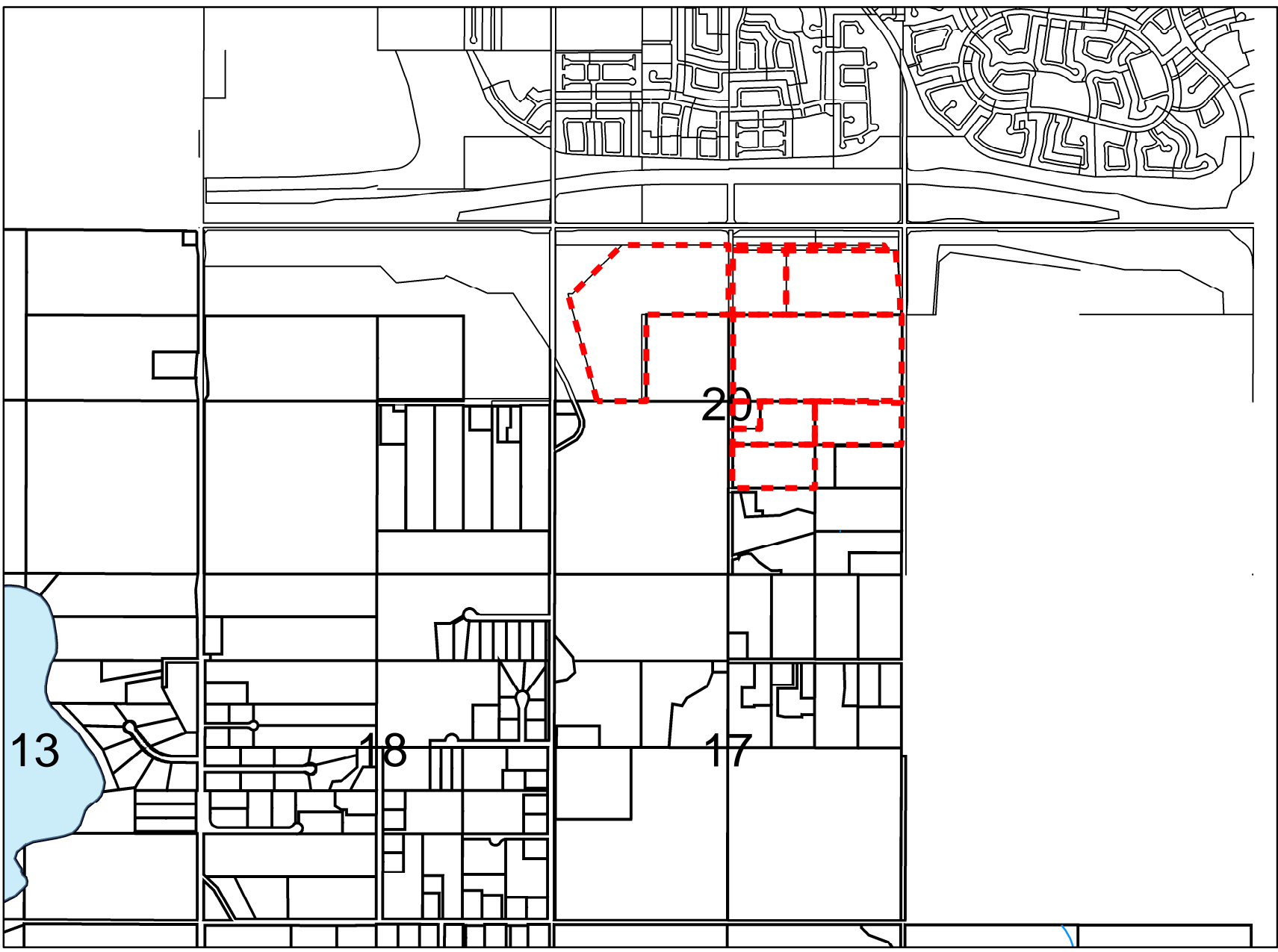
Geographic Context (Section 20 22-01 W5)



- Legend**
-  City of Calgary
 -  Municipal District of Foothills No.31
 -  Southern Properties

Scale 1:26,230



Map is compiled by the Municipal District of Foothills No. 31. Reproduction, in whole or in part, is prohibited without express permission from the Municipal District of Foothills No.31. Data Sources include Municipal Records, Atlas/LIS and City of Calgary. This map is for graphic representation purposes only.

Aug 1, 2006

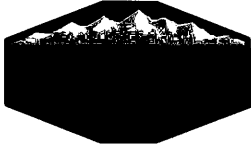

Municipal District of Foothills No. 31

309 Macleod Trail, Box 5605
High River, Alberta T1V 1M7
Telephone: (403) 652-2341 OR (403) 931-1905
Fax: (403) 652-7880
www.mdfoothills.com

COUNCIL RESOLUTION NO. 829 JULY 6, 2006 COUNCIL MEETING

SOUTHERN / SPRUCE MEADOWS

N.W. & N.E. 20-22-01 W5M

- 829 Mr. Chase moved that Council instruct staff to proceed with the annexation of land owned by Spruce Meadows into the M.D. of Foothills No. 31 from the City of Calgary, as submitted by the Planning Department.

CARRIED

CERTIFIED TO BE A TRUE COPY

MUNICIPAL DISTRICT OF FOOTHILLS NO. 31



Harry Riva Cambrin, CLGM, CET
Municipal Manager

DATED this 19 day of January, 2010.